



**Architect**

Payette Associates Inc.  
290 Congress Street, Fifth Floor  
Boston, MA 02210-1005  
Tel: 617-895-1000  
Fax: 617-895-1002

**Landscape**

Payette Associates, Inc.  
290 Congress St  
Fifth Floor  
Boston, MA 02210  
Tel: 617-895-1000

**Civil Engineer**

Milone & MacBroom  
1656, 99 Realty Dr  
Cheshire, CT 06410  
Tel: 203-271-1773

**MEP/FP Engineer**

BuroHappold  
11 Beacon St, Ste 400  
Boston, MA 02108  
Tel: 617-419-2284

**Structural Engineer**

Silman  
111 Devonshire St  
Boston, MA 02109  
Tel: 617-695-6700

**Facade Lighting**

• The East facade's sail-like planes are highlighted with lighting that accentuates their curving nature. Linear fixtures light each plane from the back of the preceding plane. See following pages for more details on this element.

An alternate scheme uses a single fixture at the top corner of a plane to light each sail with a diagonal wash of light.

Each of these schemes can be combined with dimming, tunable white or color changing lighting to create a subtle rippling effect on the sails. See following pages for more details on the facade lighting.

• The West facade is crowned with the lighthouse lens in the stair tower which will be internally illuminated.

This lens sits on the facade which is illuminated by a linear fixture that grazes down the facade.

The 2nd floor bridge entry to the museum has the Coast Guard Red wall which is illuminated by recessed uplights in the floor. See following pages for more details on the facade lighting.



1 Sails Rendering Linear Option  
Scale: N/A



3 Back of Building Facade Rendering  
Scale: N/A



Sail Lighting Example



Sail Lighting Fixture



Diagonal Wash Example



Diagonal Wash Fixture



2 Sails Rendering Alternate Diagonal Option  
Scale: N/A

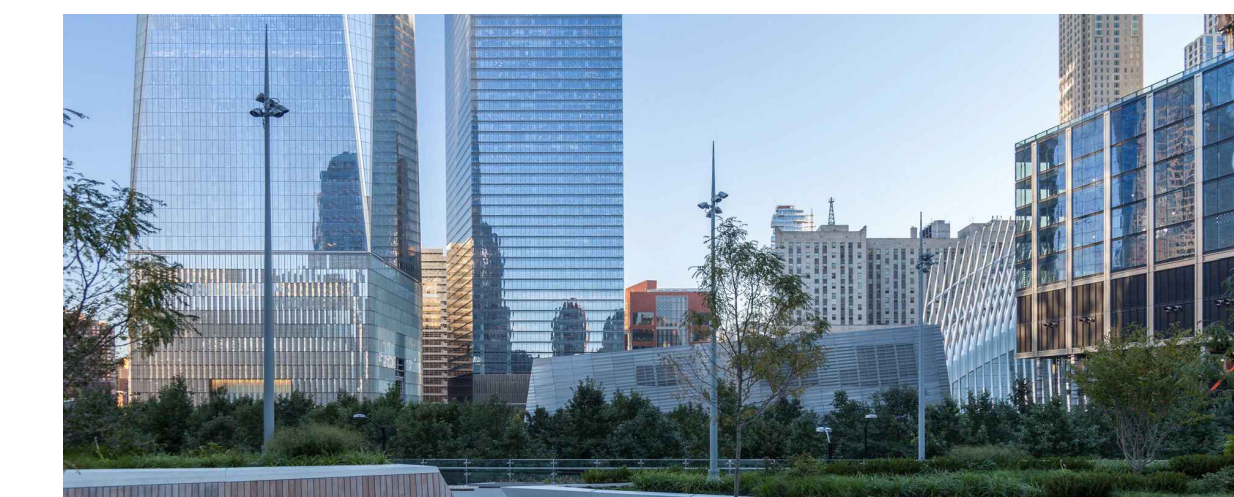

Light Pole Options



Bollard Options

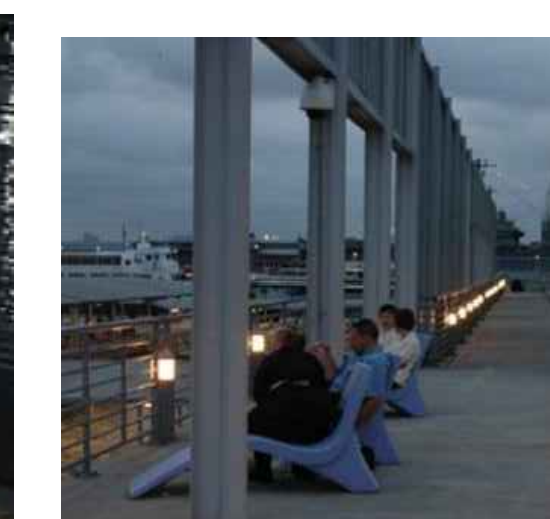

#	DATE	DESCRIPTION
04/06/18	04/06/18	SCHEMATIC DESIGN

**SCHEMATIC DESIGN**

**NATIONAL COAST GUARD MUSEUM**

**Facade Lighting Renderings**

Drawing Scale	As indicated
Project Number	16201.00
Date Issued	04/04/18

**AL1.02**

**Architect**

Payette Associates Inc.  
290 Congress Street, Fifth Floor  
Boston, MA 02210-1005  
Tel: 617-895-1000  
Fax: 617-895-1002

**Landscape**

Payette Associates, Inc.  
290 Congress St  
Fifth Floor  
Boston, MA 02210  
Tel: 617-895-1000

**Civil Engineer**

Milone & MacBroom  
1656, 99 Realty Dr  
Cheshire, CT 06410  
Tel: 203-271-1773

**MEP/FP Engineer**

BuroHappold  
11 Beacon St, Ste 400  
Boston, MA 02108  
Tel: 617-419-2284

**Structural Engineer**

Silman  
111 Devonshire St  
Boston, MA 02109  
Tel: 617-695-6700

**Entry Level**

- In the entry, simple industrial downlights will provide general lighting. Stairs may have integrated lighting in handrails or risers to create a signature sculptural element.
- In the entry, simple industrial downlights will provide general lighting. Stairs may have integrated lighting in handrails or risers to create a signature sculptural element.
- The night-time approaches from the plaza highlight the full-height facade with the helicopter and rescue personnel suspended within. This presents an opportunity for a dramatic presentation at night, to evoke a rescue at sea. Theatrical lighting, potentially combined with projection and sound could tell the story of the helicopter flying into a storm, and lowering the rescue personnel to aid those in need. See following pages for more details on this element.
- A sophisticated yet easy to use control system will dim lights on and off, and run dynamic effects, operating on astronomical or timeclock event scheduling with customizable scheduling.



Track and Track Fixtures

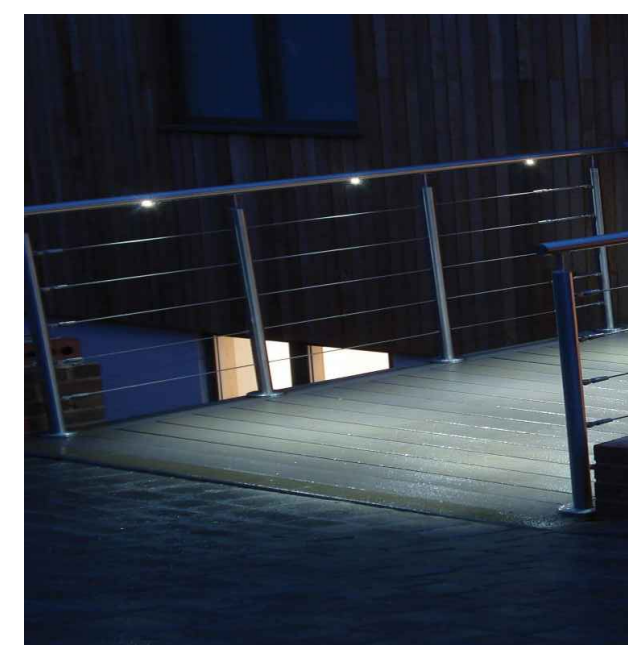

Railing Lighting



Downlight Fixtures



Industrial Fixtures for Circulation

#	DATE	DESCRIPTION
	04/06/18	SCHEMATIC DESIGN

**SCHEMATIC DESIGN**

**NATIONAL COAST GUARD MUSEUM**

**GROUND LEVEL LIGHTING LAYOUT**

Drawing Scale	As indicated
Project Number	16201.00
Date Issued	04/04/18

**AL2.00**

**Architect**

Payette Associates Inc.  
290 Congress Street, Fifth Floor  
Boston, MA 02210-1005  
Tel: 617-895-1000  
Fax: 617-895-1002

**Landscape**

Payette Associates, Inc.  
290 Congress St  
Fifth Floor  
Boston, MA 02210  
Tel: 617-895-1000

**Civil Engineer**

Milone & MacBroom  
1656, 99 Realty Dr  
Cheshire, CT 06410  
Tel: 203-271-1773

**MEP/FP Engineer**

BuroHappold  
11 Beacon St, Ste 400  
Boston, MA 02108  
Tel: 617-419-2284

**Structural Engineer**

Silman  
111 Devonshire St  
Boston, MA 02109  
Tel: 617-695-6700

- Lobby**
- In the lobby, simple industrial downlights will provide general lighting. Lighting elements will be organized to integrate with ceiling or structural elements in a sympathetic way.
  - Accent lighting from track fixtures will be incorporated into the lobby to highlight any feature or exhibit elements.
  - Stairs may have integrated lighting in handrails or risers to create a signature sculptural element.
  - A sophisticated yet easy to use control system will dim lights on and off, and run dynamic effects, operating on astronomic or timedclock event scheduling with customizable scheduling.

**Theater**

- The theatre program will incorporate lighting for film presentations as well as lectures and panel discussions. Dimming for multiple light levels as well as directional lighting for speakers will be incorporated. Lighting for dramatic or musical performances is not planned at this time.
- Dimming controls and interfaces to AV systems are planned

**Restroom Lighting**

- Restrooms will have simple lighting with perimeter slots along wet walls, downlights for circulation, and lights over sinks.

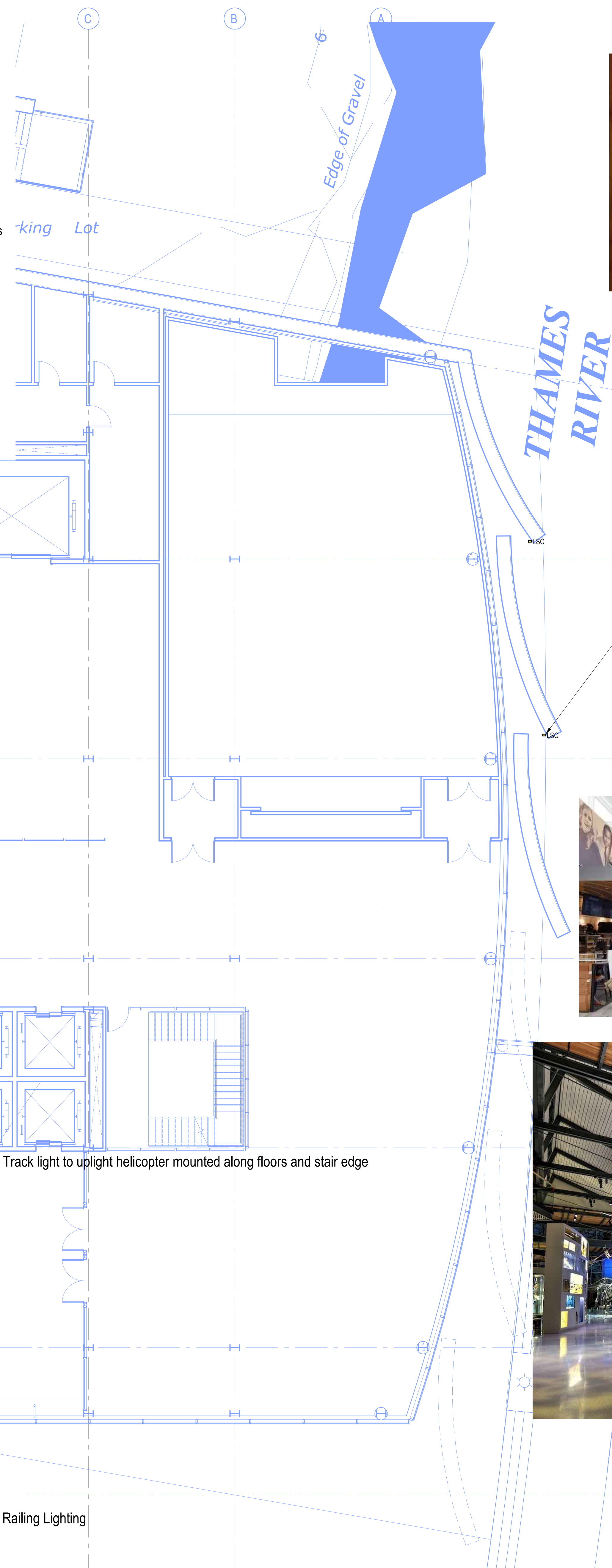

Track Fixtures



Downlight Fixtures

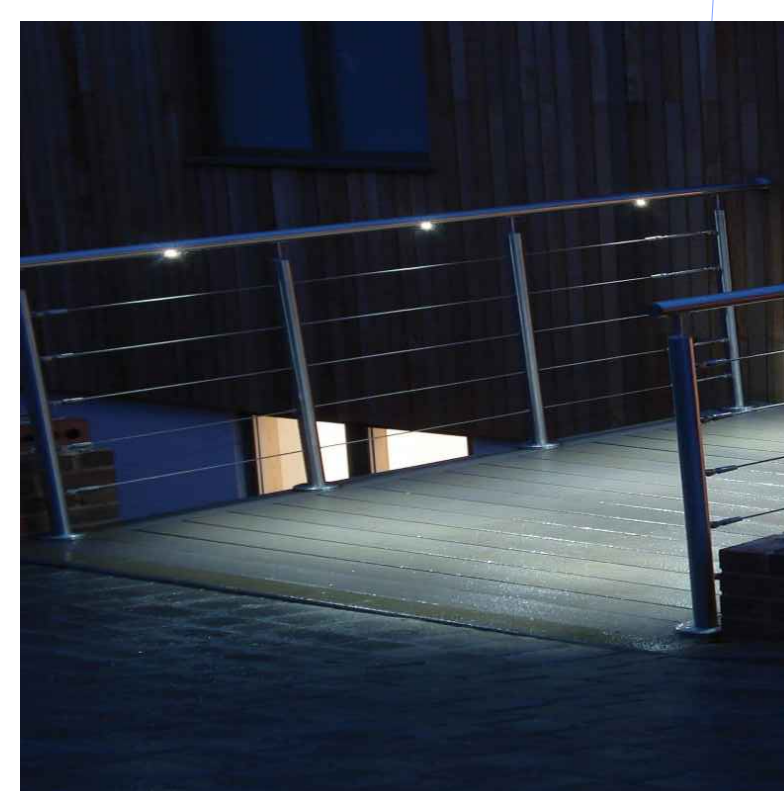

Railing Lighting

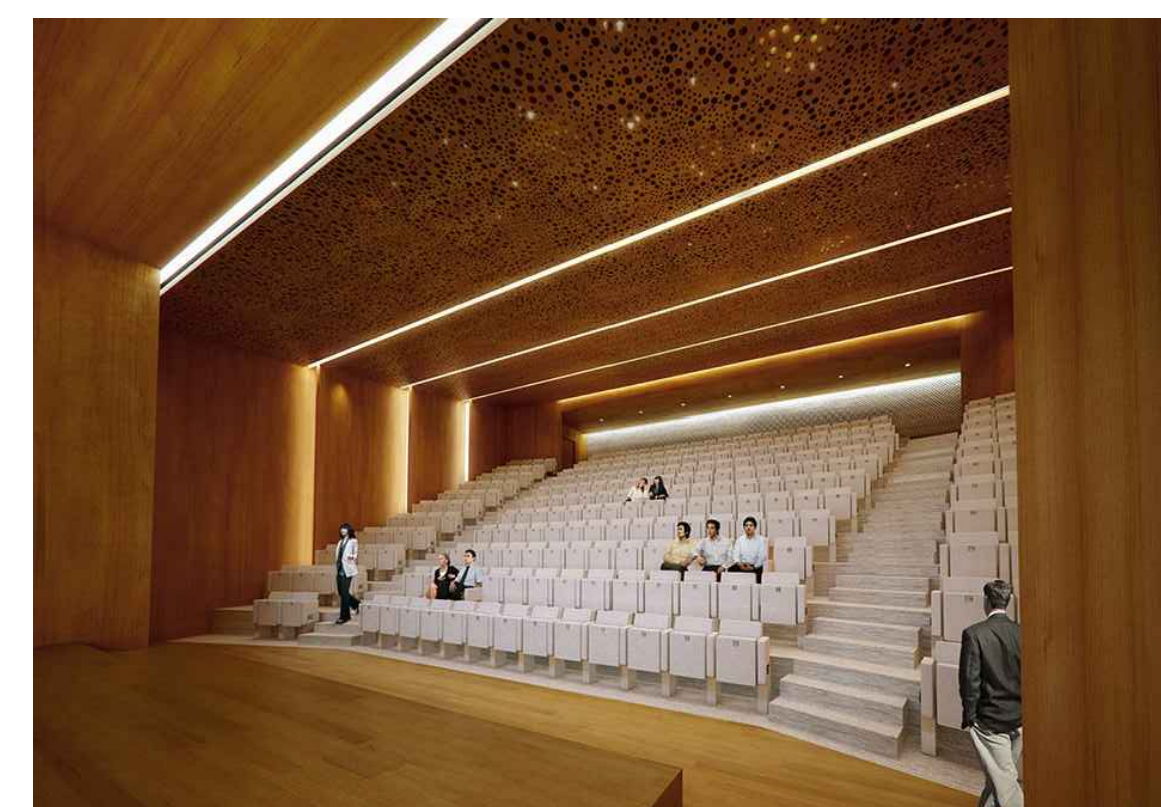

Theatre Lighting Examples

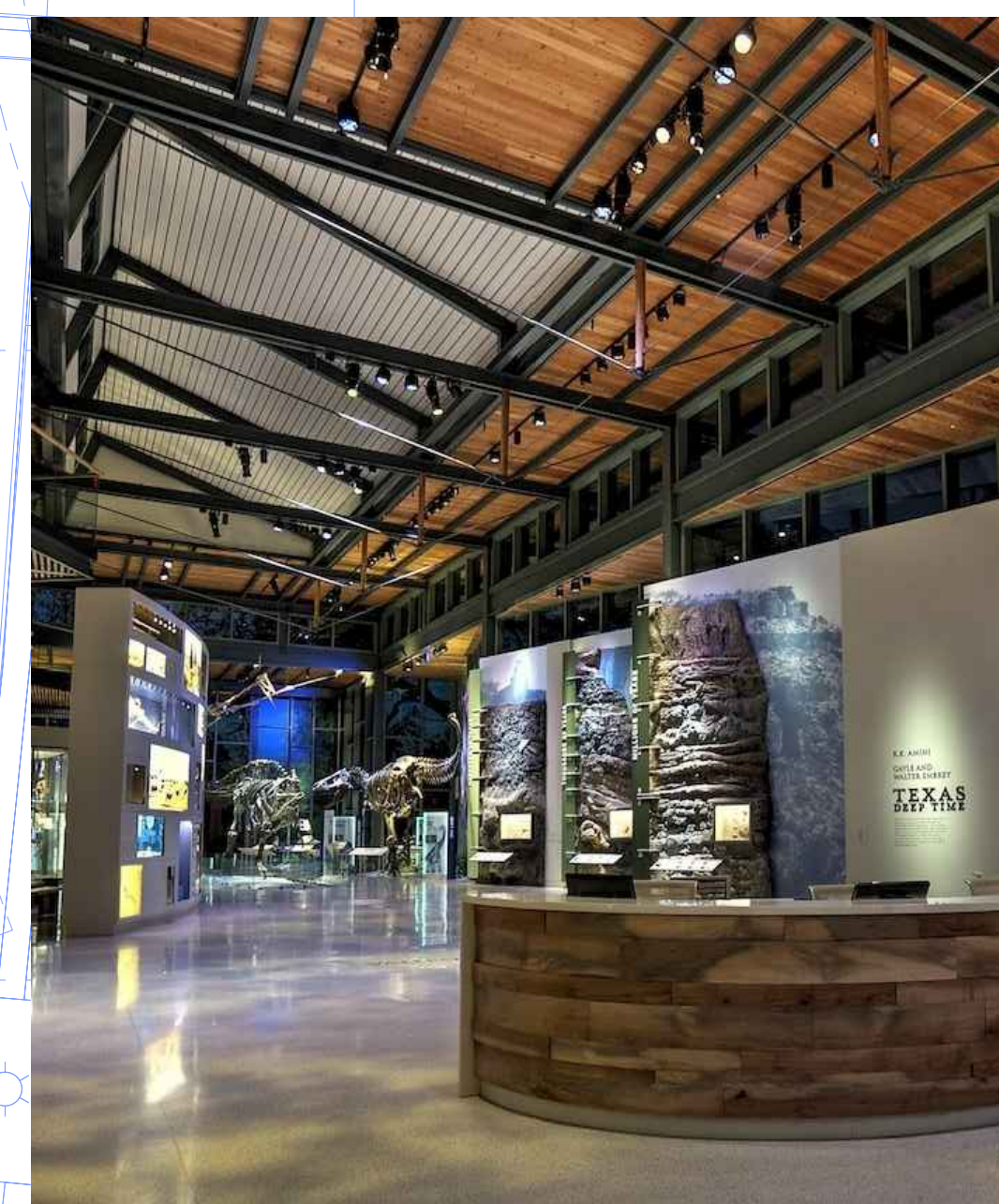

Lobby Lighting Examples

#	DATE	DESCRIPTION
04/06/18	SCHEMATIC DESIGN	

**SCHEMATIC DESIGN**

**NATIONAL COAST GUARD MUSEUM**

**LEVEL 1 LIGHTING LAYOUT**

Drawing Scale	As indicated
Project Number	16201.00
Date Issued	04/04/18

**Architect**

Payette Associates Inc.  
290 Congress Street, Fifth Floor  
Boston, MA 02210-1005  
Tel: 617-895-1000  
Fax: 617-895-1002

**Landscape**

Payette Associates, Inc.  
290 Congress St  
Fifth Floor  
Boston, MA 02210  
Tel: 617-895-1000

**Civil Engineer**

Milone & MacBroom  
1656, 99 Realty Dr  
Cheshire, CT 06410  
Tel: 203-271-1773

**MEP/FP Engineer**

BuroHappold  
11 Beacon St, Ste 400  
Boston, MA 02108  
Tel: 617-419-2284

**Structural Engineer**

Silman  
111 Devonshire St  
Boston, MA 02109  
Tel: 617-695-6700

**Exhibit Galleries**

- A pipe grid with power and DMX lighting data distribution will provide flexibility for lighting exhibits. As an alternate, track could be used instead of pipe.

- Worklights for exhibit galleries may be simple cylinder downlights. Worklights are normally off during visitor hours.

**Bridge**

- The 2nd floor bridge entry to the museum has the Coast Guard Red wall which is illuminated by recessed uplights in the floor.

- Other bridge elements include ceiling elements at major nodes (stairs, elevator); recessed uplight to highlight structure and provide indirect illumination.

- Stairs may have integrated lighting in handrails or risers to create a signature sculptural element.

- Elevator towers will have uplight at base to provide glow and highlight the elevator as it moves.

**Restroom Lighting**

- Restrooms will have simple lighting with perimeter slots along wet walls, downlights for circulation, and lights over sinks.



Recessed linear Uplight



Recessed linear uplights to light coast guard red wall

Lighting position to uplight atrium helicopter lighting

Railing Lighting For Stairs

Exhibit accent lighting will be pipe-mounted on a pipe grid at approximately 15'-0" AFF to pipe. Pipes are schedule 40 1-1/2" steel pipes mounted light theatrical hardware so no rotation or deflection can occur.



Pendant Worklight

Gallery work lights will include pendant-mounted downlights mounted at approximately 15'-0" AFF

Linear fixture mounted vertically to light sails

#	DATE	DESCRIPTION
04/06/18	SCHEMATIC DESIGN	

**SCHEMATIC DESIGN**

**NATIONAL COAST GUARD MUSEUM**

**LEVEL 2 LIGHTING LAYOUT**

Drawing Scale	As indicated
Project Number	16201.00
Date Issued	04/04/18



**Architect**  
 Payette Associates Inc.  
 290 Congress Street, Fifth Floor  
 Boston, MA 02210-1005  
 Tel: 617-895-1000  
 Fax: 617-895-1002

<b>Landscape</b> Payette Associates, Inc. 290 Congress St Fifth Floor Boston, MA 02210 Tel: 617-895-1000	<b>Civil Engineer</b> Milone & MacBroom 1656, 99 Realty Dr Cheshire, CT 06410 Tel: 203-271-1773
---	---

<b>MEP/FP Engineer</b> BuroHappold 11 Beacon St, Ste 400 Boston, MA 02108 Tel: 617-419-2284	<b>Structural Engineer</b> Silman 111 Devonshire St Boston, MA 02109 Tel: 617-695-6700
---	--

### Event Center Lighting

- The event center will incorporate lighting for multiple uses including meetings, dinners and parties. Layers of light and flexible systems will accommodate these uses.
- Additional infrastructure for temporary party lighting by outside vendors may be necessary.
- Dimming controls and interfaces to AV systems are planned.

### Facade

- The East facade's sail-like planes are highlighted with lighting that accentuates their curving nature. Linear fixtures light each plane from the back of the preceding plane. See following pages for more details on this element.  
 An alternate scheme uses a single fixture at the top corner of a plane to light each sail with a diagonal wash of light. Each of these schemes can be combined with dimming, tunable white or color changing lighting to create a subtle rippling effect on the sails.

- The West facade is crowned with the lighthouse lens in the stair tower which will be internally illuminated. This lens sits on the facade which is illuminated by a linear fixture that grazes down the facade.

### Restroom Lighting

- Restrooms will have simple lighting with perimeter slots along wet walls, downlights for circulation, and lights over sinks.

### Office Lighting

- Suspended direct / indirect pendants and task lighting on desk provide illumination at task area.

Lantern to be internally illuminated

Linear graze downlight at top of wall

1 Level 5 Lighting Layout  
 Scale: 1/8" = 1'-0"

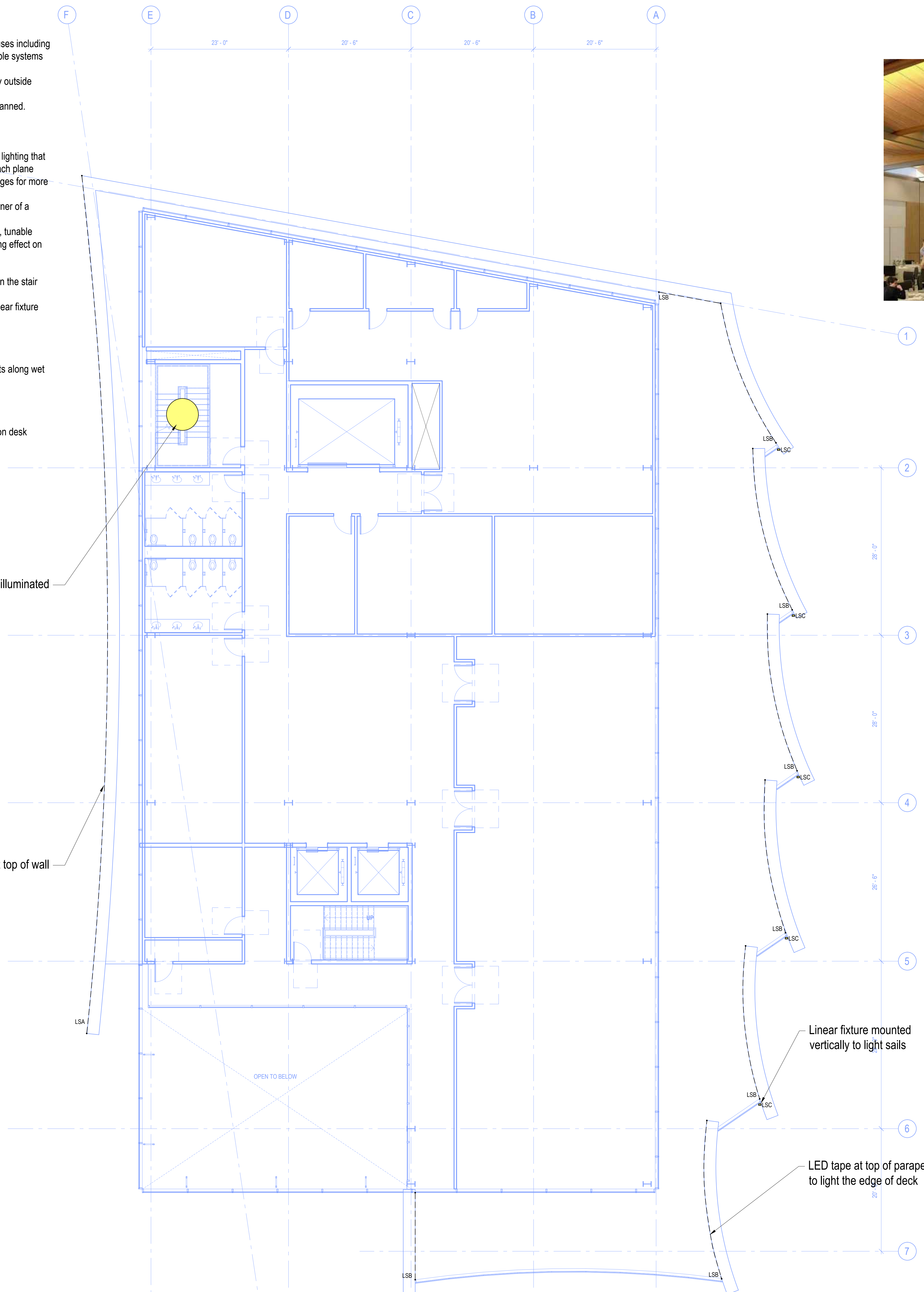

Event Space Examples

#	DATE	DESCRIPTION
	04/06/18	SCHEMATIC DESIGN

SCHEMATIC DESIGN

NATIONAL COAST  
 GUARD MUSEUM

LEVEL 5  
 LIGHTING LAYOUT

Drawing Scale	As indicated
Project Number	16201.00
Date Issued	04/04/18

AL2.05

**Bridge**

- The 2nd floor bridge entry to the museum has the Coast Guard Red wall which is illuminated by recessed uplights in the floor.
- Other bridge elements include ceiling elements at major nodes (stairs, elevator); recessed uplight to highlight structure and provide indirect illumination.
- Stairs may have integrated lighting in handrails or risers to create a signature sculptural element.
- Elevator towers will have uplight at base to provide glow and highlight the elevator as it moves.

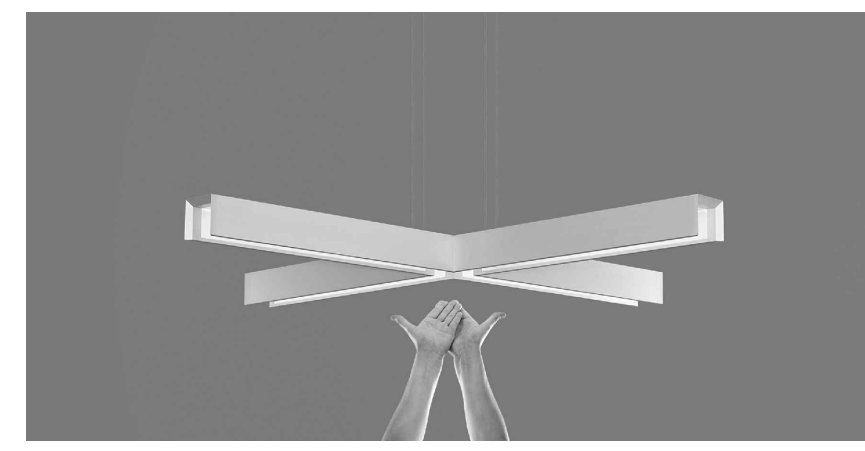

Direct / Indirect Pendant to Mark Nodes

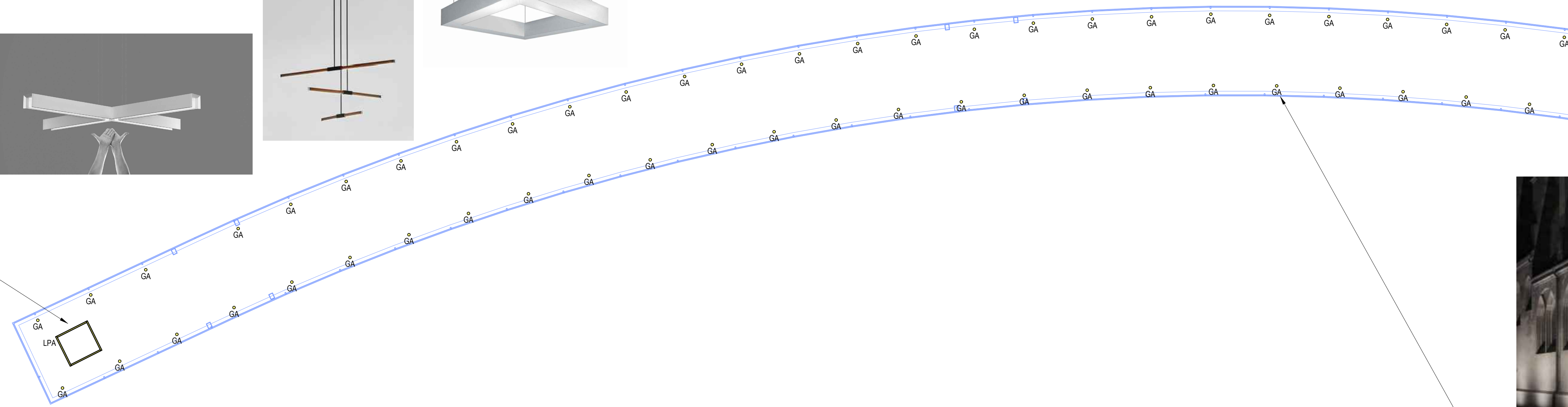

Recessed Uplights in Floor Highlight Structure & Provide indirect light

**1** Bridge Lighting Layout West  
Scale: 1/8" = 1'-0"

Direct / Indirect Pendant to Mark Nodes

Railing Lighting

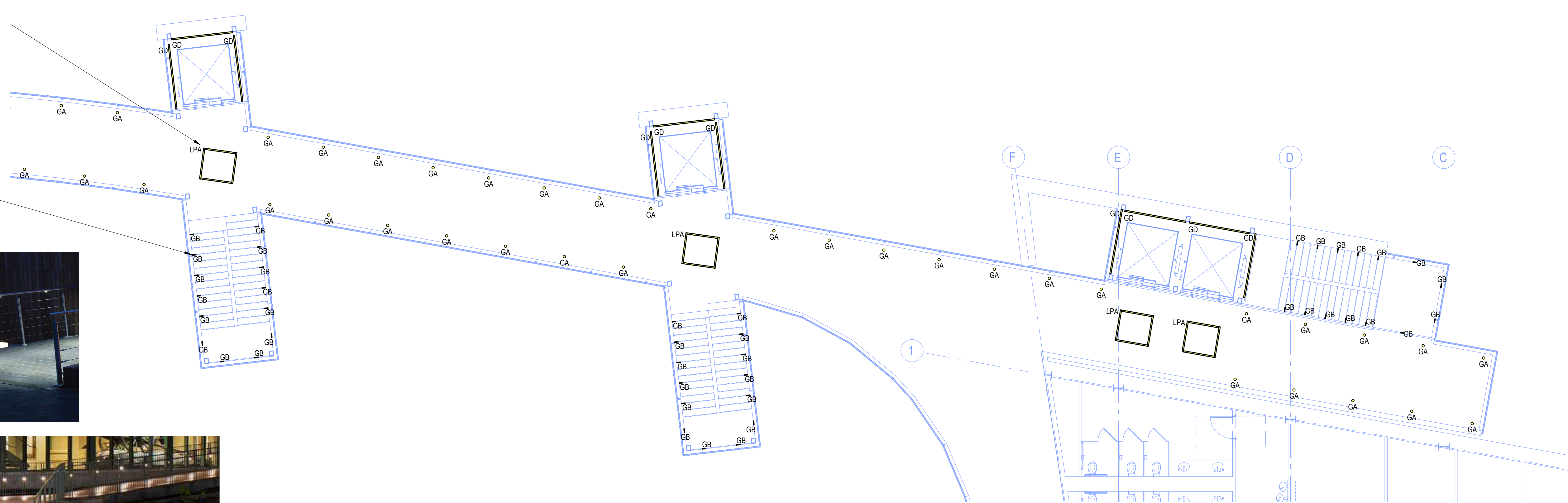
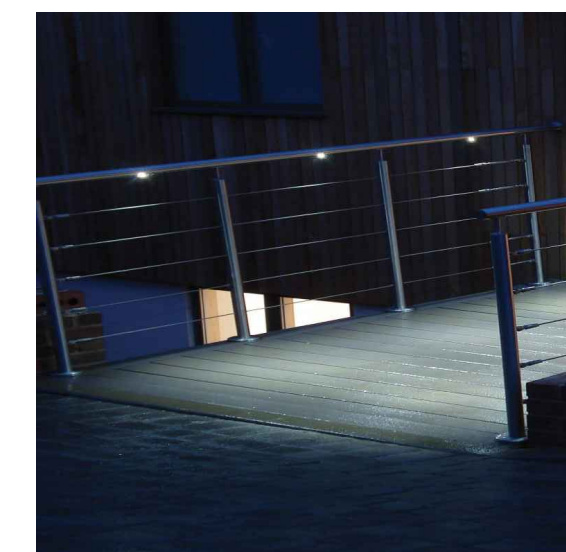

**2** Bridge Lighting Layout East  
Scale: 1/8" = 1'-0"

**PAYETTE**

**Architect**

Payette Associates Inc.  
290 Congress Street, Fifth Floor  
Boston, MA 02210-1005  
Tel: 617-895-1000  
Fax: 617-895-1002

**Landscape**

Payette Associates, Inc.  
290 Congress St  
Boston, MA 02210  
Tel: 617-895-1000

**Civil Engineer**

Milone & MacBroom  
1656, 99 Realty Dr  
Cheshire, CT 06410  
Tel: 203-271-1773

**MEP/FP Engineer**

BuroHappold  
11 Beacon St, Ste 400  
Boston, MA 02108  
Tel: 617-419-2284

**Structural Engineer**

Silman  
111 Devonshire St  
Boston, MA 02109  
Tel: 617-695-6700

#	DATE	DESCRIPTION
	04/06/18	SCHEMATIC DESIGN

**SCHEMATIC DESIGN**

**NATIONAL COAST  
GUARD MUSEUM**

**BRIDGE  
LIGHTING LAYOUT**

Drawing Scale  
As indicated

Project Number  
16201.00

Date Issued  
04/04/18

**AL2.06**